

# MURRAY COUNTY.

Section 19

Township 105

Range 42

10798 McGill-Warner Co., Blank Book Manufacturers, St. Paul.

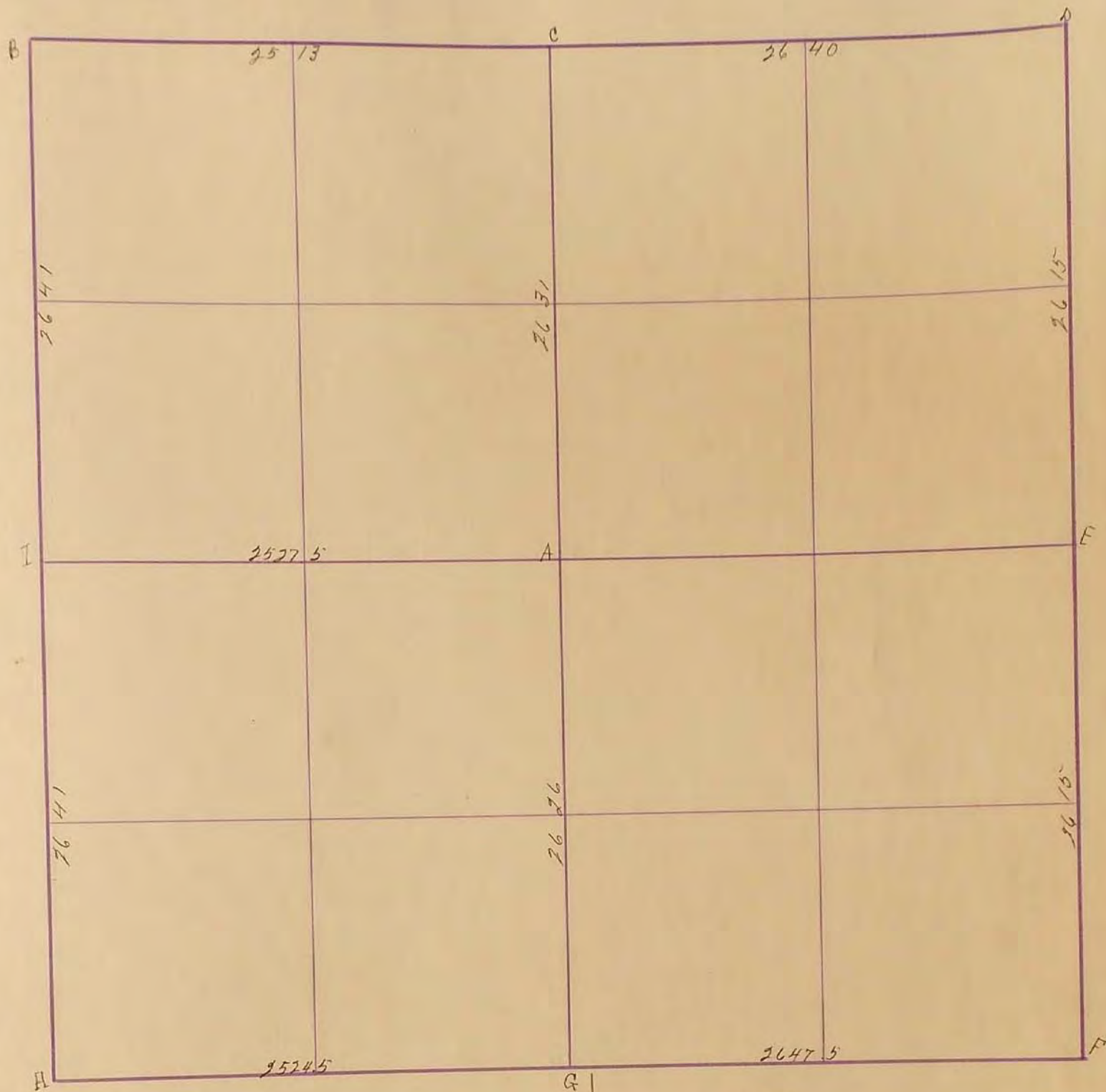

Apr 26-1901

- A. 12 X 16 X 24
- B. Stone 10 X 12 X 26-33' of Bridge
- C.
- D. Stone 12 X 12 X 22 in grade
- E.
- F. Stone in grade & stone
- G. Stone N. side of grade 10 X 12 X 18
- H. Stone in grade 10 X 12 X 16 on large stone
- I. Stone 12 X 12 X 24

J. H. Woolstiner draft

Sept. 19 1927

- B. Placed two stones on top of original stone.
- F. Cor. 50' N.W. F. Cor. 48.0 N.E. F. Cor. 44.8 S.E. F. Cor. 45.8 S.W.
- H. Stone 10 X 10 X 18 F. Cor. 45.6 N.E. T.P. 38.5 S.E. F. Cor. 42.5 S.W.
- F. Cor. 45.0 N.W.
- I. Placed stone 6 X 10 X 16 Blue F. Cor. 29' E on line
- F.P. 38.2 S.W. F.P. 34.8 N.W.
- "G" Assumed Cor. Placed 3/4" x 6" Iron Rod, April 7, 1967; R.P. N&C, Cor. Fence Post North 26.55'; R.P. First Steel Fence Post NE. 50.3'
- "F" Located 3/4" iron pin 9" below grade, April 6, 1967; R.P. N&C, T.C.T NW. 45.65'; R.P. N&C, Cor. Post NE. 47.4'; R.P. N&C, P.P. SW. 44.3'

1969

- G. Iron Rod. R.P. "x" on top of Colv. NW-39.35' SW-37.75'
- F. Iron Rod R.P. "x" on Apron SE. 51.15' N+C P.P. SW-60.55'

18  
19  
20  
21  
22  
23  
24  
25  
26  
27  
28  
29  
30  
31  
32  
33  
34  
35  
36

SURVEY No. \_\_\_\_\_

Section 19  
45.1

Town 105

Range 42

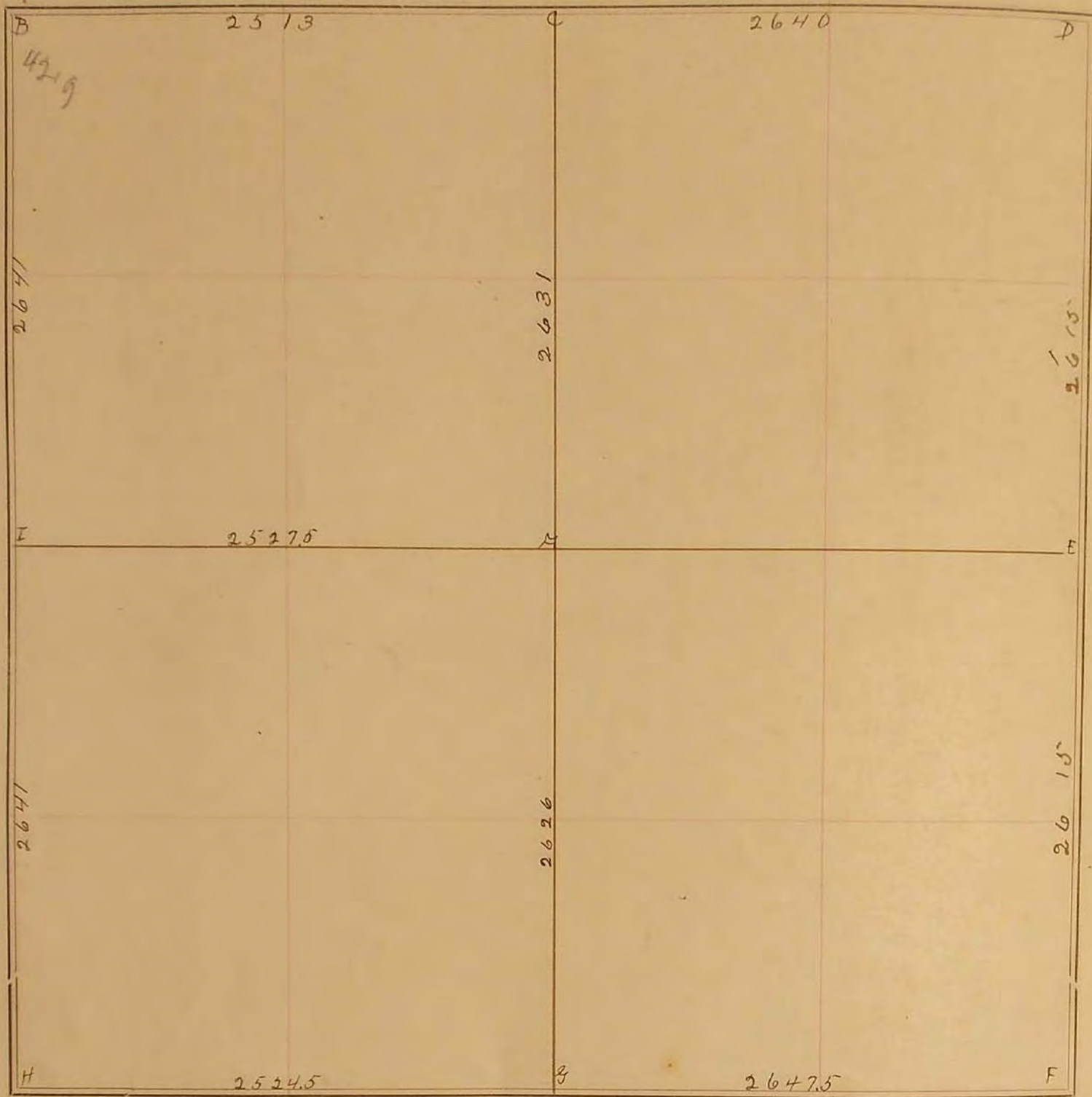

FIELD NOTES.

Apr. 26, 1901.

- A 12 x 16 x 24
- B Stone 10 x 12 x 26 33' of Bridge
- C
- D Stone 12 x 12 x 22 in grade
- E
- F Stone in grade + stake
- G " n. side of grade 10 x 12 x 18
- H " in grade 10 x 12 x 16 on large stone
- I " 12 x 12 x 24

*J. W. Woolstencroft*

Sept 19, 1927

B. placed two stones on top of original stone. F. cor. 50' N.W. F. cor. 480' N.E. F. cor. 445' S.E.  
 H. Stone 10 x 10 x 18 F. cor. 45.6 N.E. T.P. 38.5 S.E. F. cor. 45.5 S.W. F. cor. 45.0 N.W.  
 I placed stone 6 x 10 x 16. Blue. F. cor. 29' E. on line. F.P. 38.2 S.W. F.P. 34.8 N.W.

2620	262.5	
2615	2647	
52410	18375	159.51
	10500	
	15750	
	5250	
	6948375	
	73560	
	259237	
	217900	
	414375	
	392040	
	223350	
	217500	
	56500	